

# CADERNO EXECUTIVO

Projeto de interiores  
Detalhamentos

✉ [thais.barauna@outlook.com](mailto:thais.barauna@outlook.com)

☎ (49) 9 9915-0025

📷 [@thaisbarauna.arq](https://www.instagram.com/thaisbarauna.arq)

THAÍS|  
BARAUNA  
*arquitetura*

## ESPECIFICAÇÕES GERAIS

Cor: Nobile

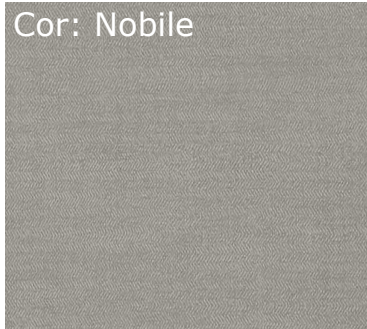

Cor: Portoro



Reformas:

conferir tonalidades  
in loco



Cor: Itapuã



Perfis LED de embutir 4.000K

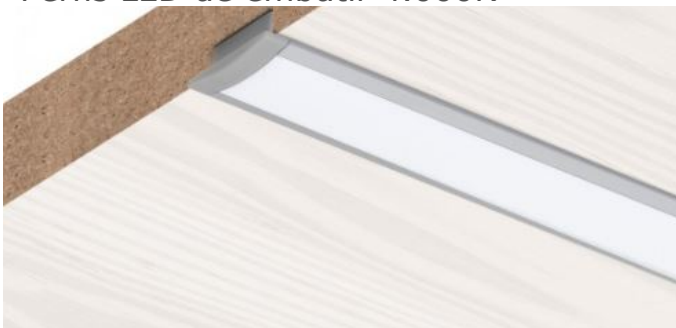

## ORIENTAÇÕES GERAIS

- . Antes do início da execução deverá ser marcada reunião;
- . Todas as medidas devem obrigatoriamente serem conferidas no local antes de qualquer execução;
- . Mobiliário deverá ser produzido em MDF 18 mm;
- . Quando houver puxadores não especificados no mobiliário, os mesmos deverão ser definidos junto ao pessoal terceirizado;
- . Após a realização de cada serviço prestado o responsável deve executar a limpeza do local, no que diz respeito ao seu trabalho;
- . Qualquer dúvida deve ser solucionada com a presença da Arquiteta responsável (antes da execução).

THAÍS|  
BARAUNA  
*arquitetura*

# ORDEM DE APRESENTAÇÃO DO CADERNO

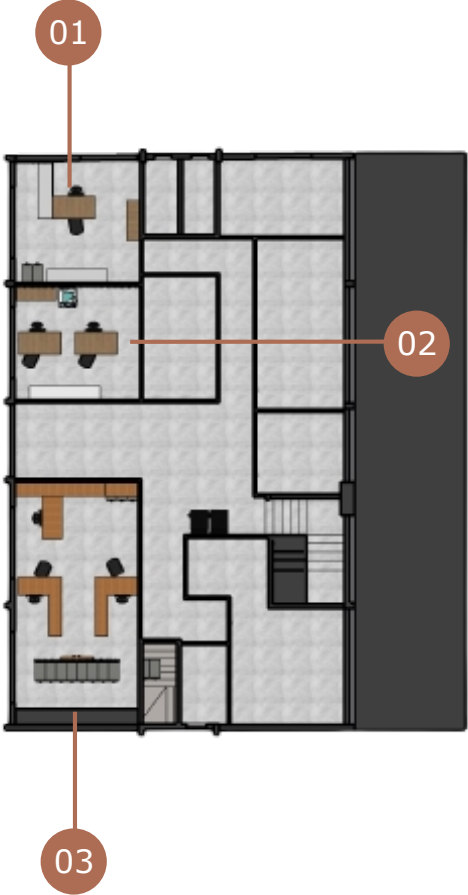

Planta Baixa - Pav Térreo  
*FRENTE*

Sala 01

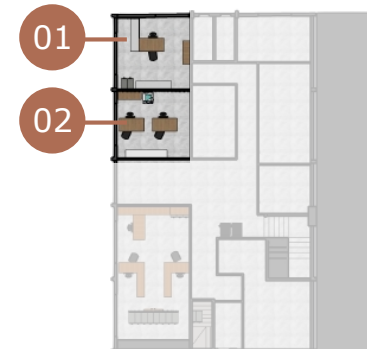

Sala 02



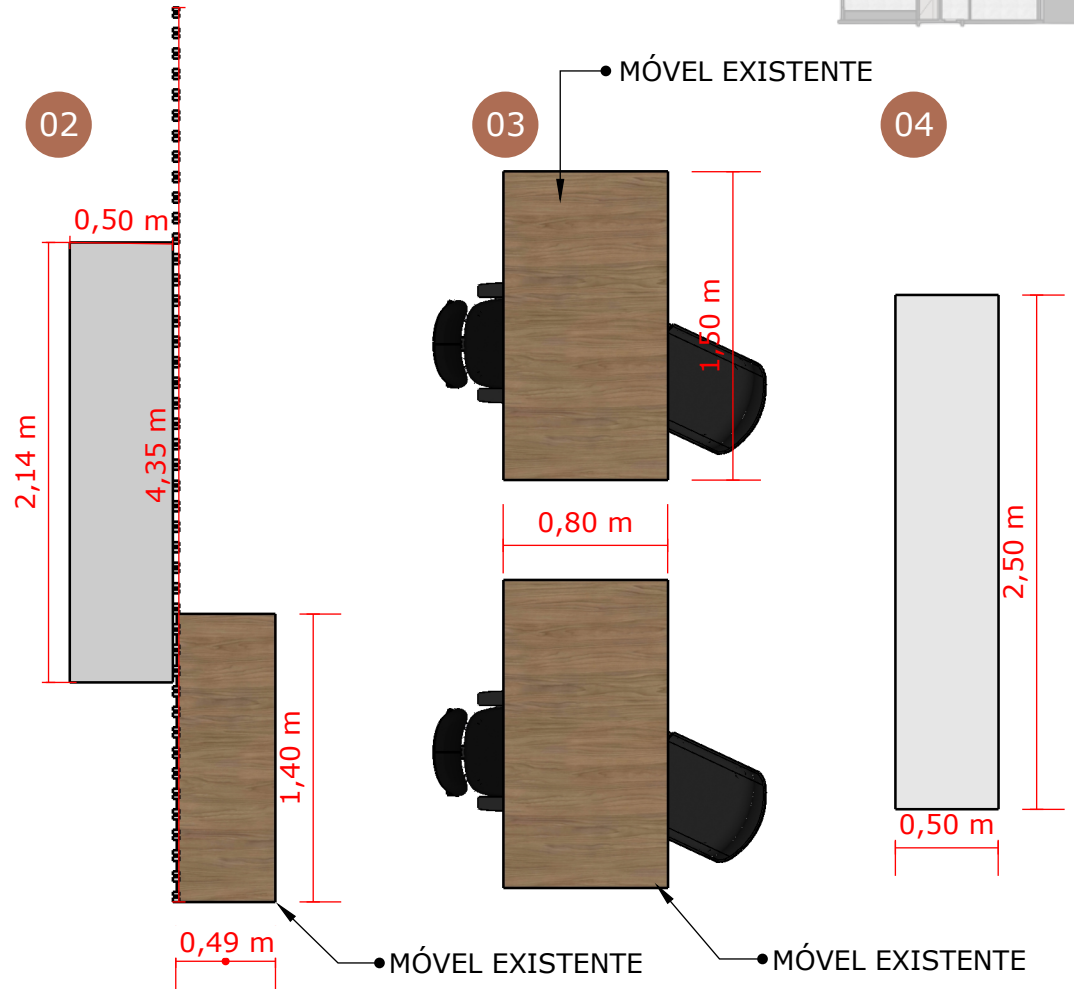
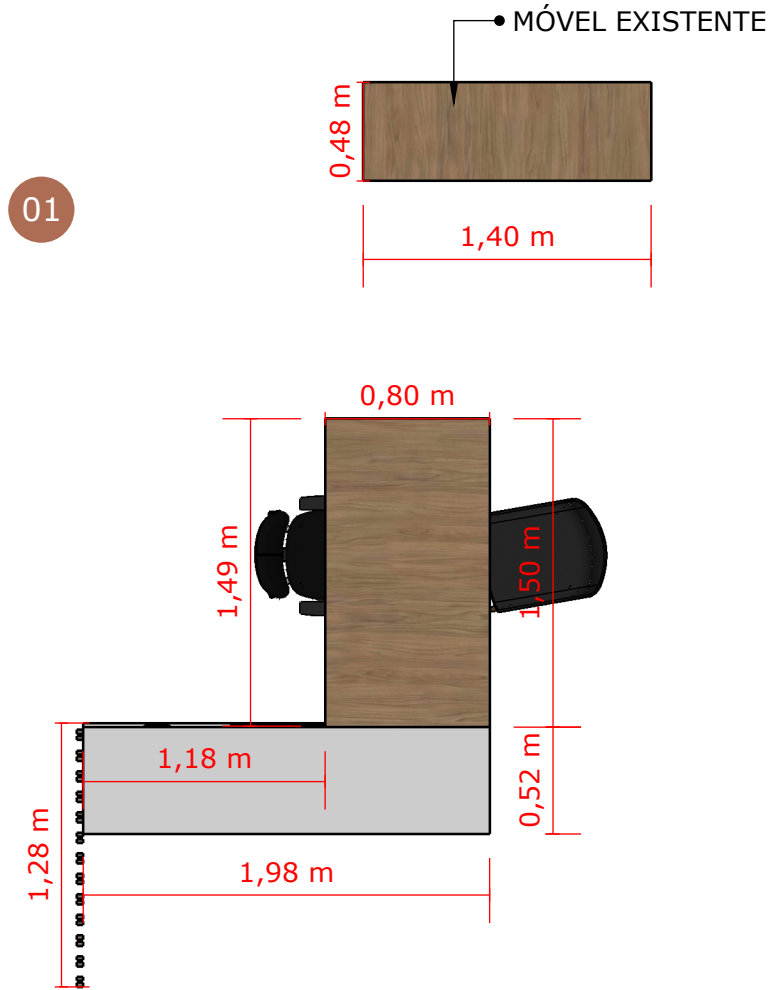

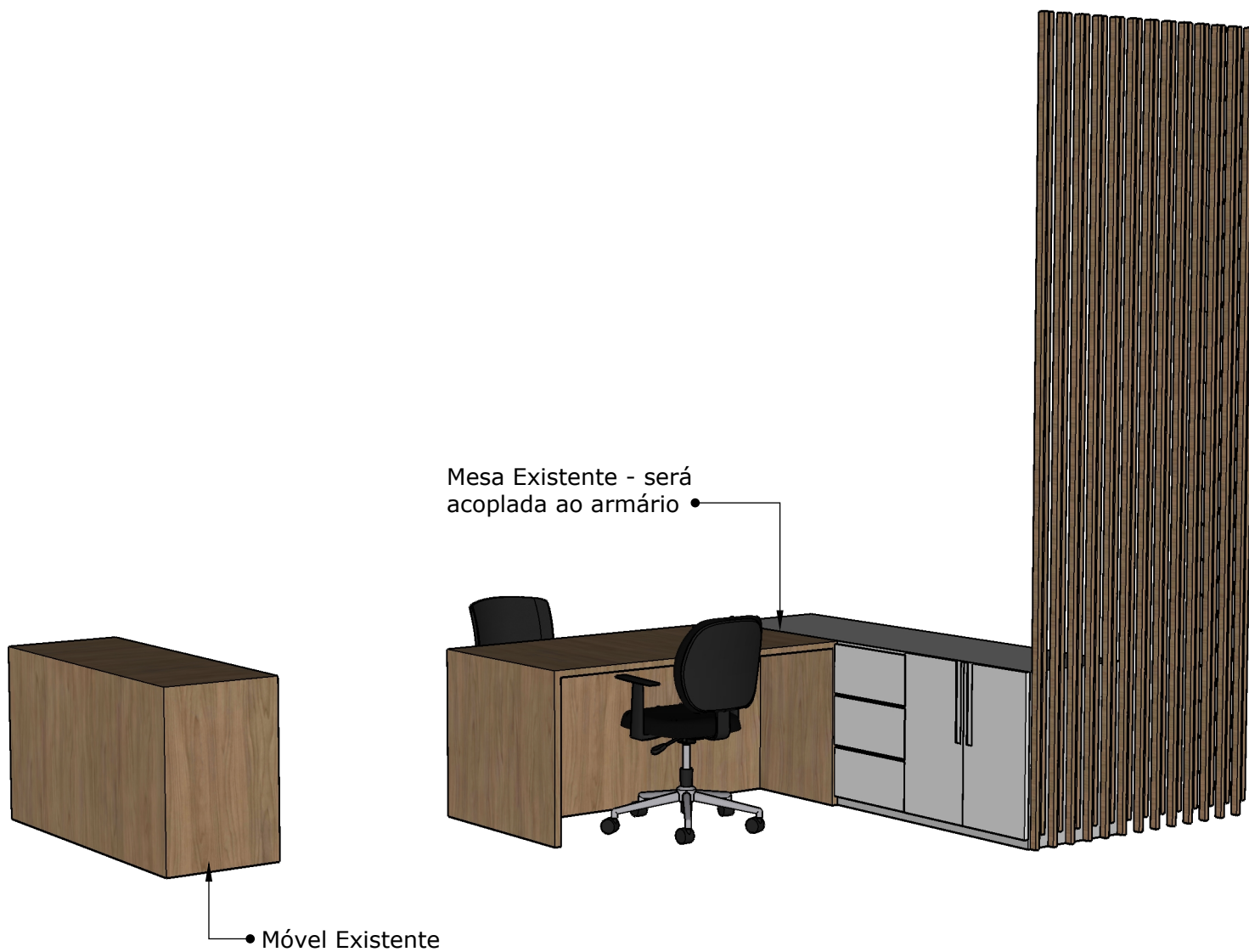

VISTA EXTERNA 01  
(perspectiva)

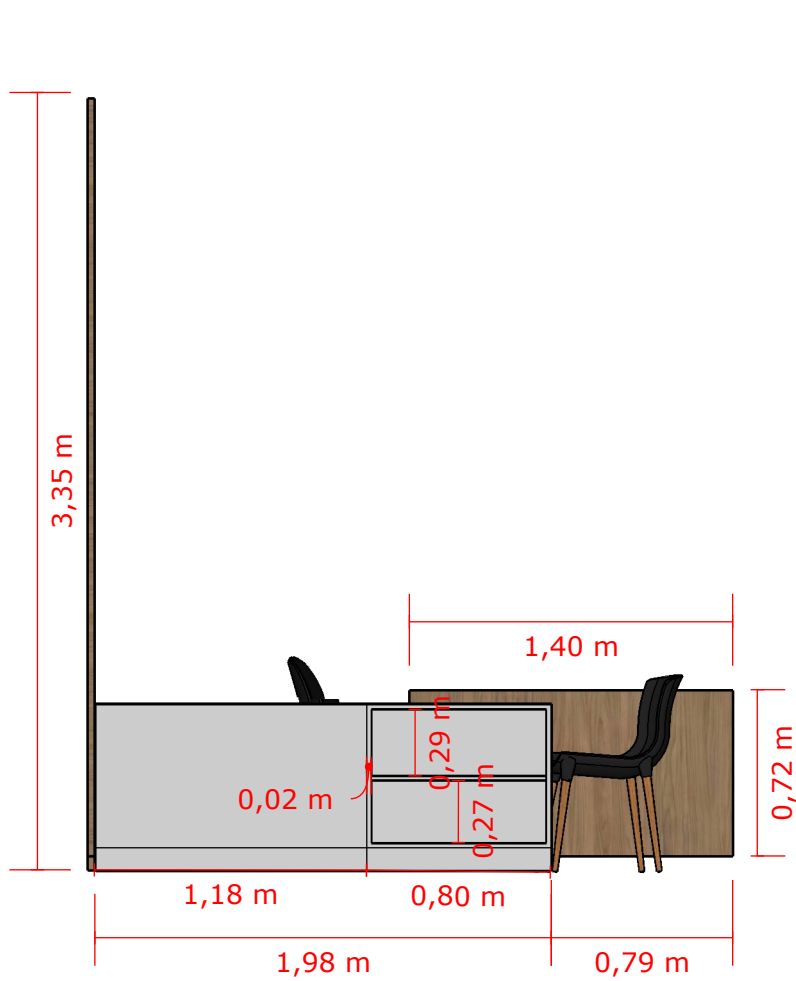

VISTA EXTERNA 01  
(lateral)

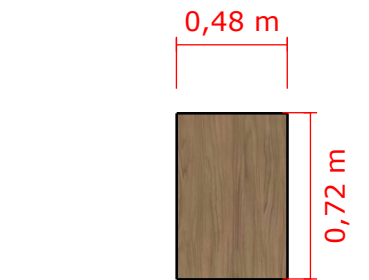
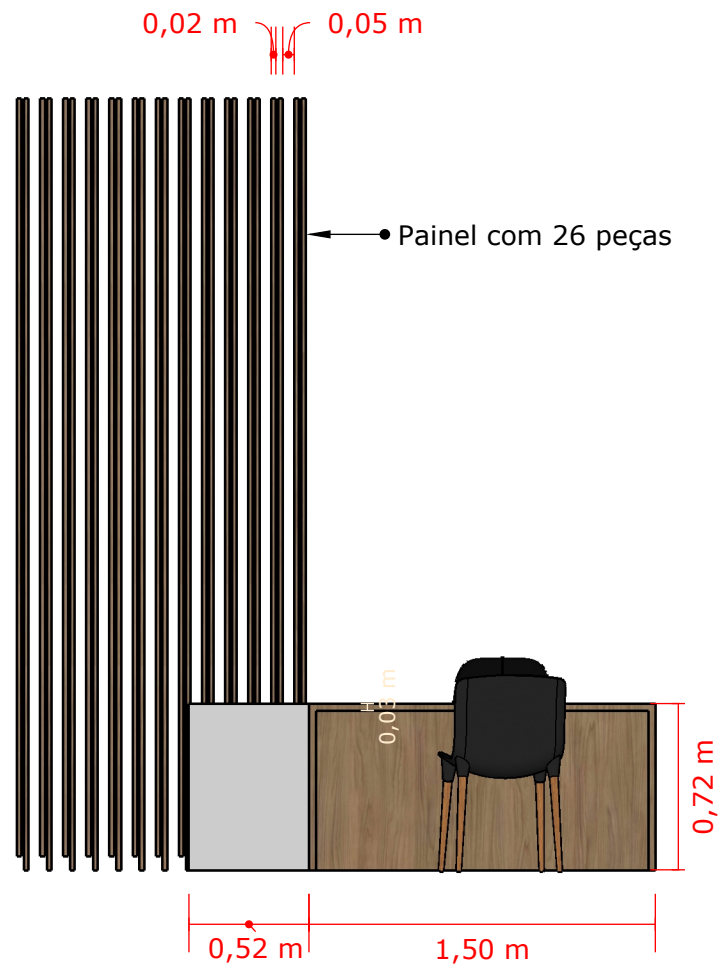

VISTA EXTERNA 01  
(frontal)

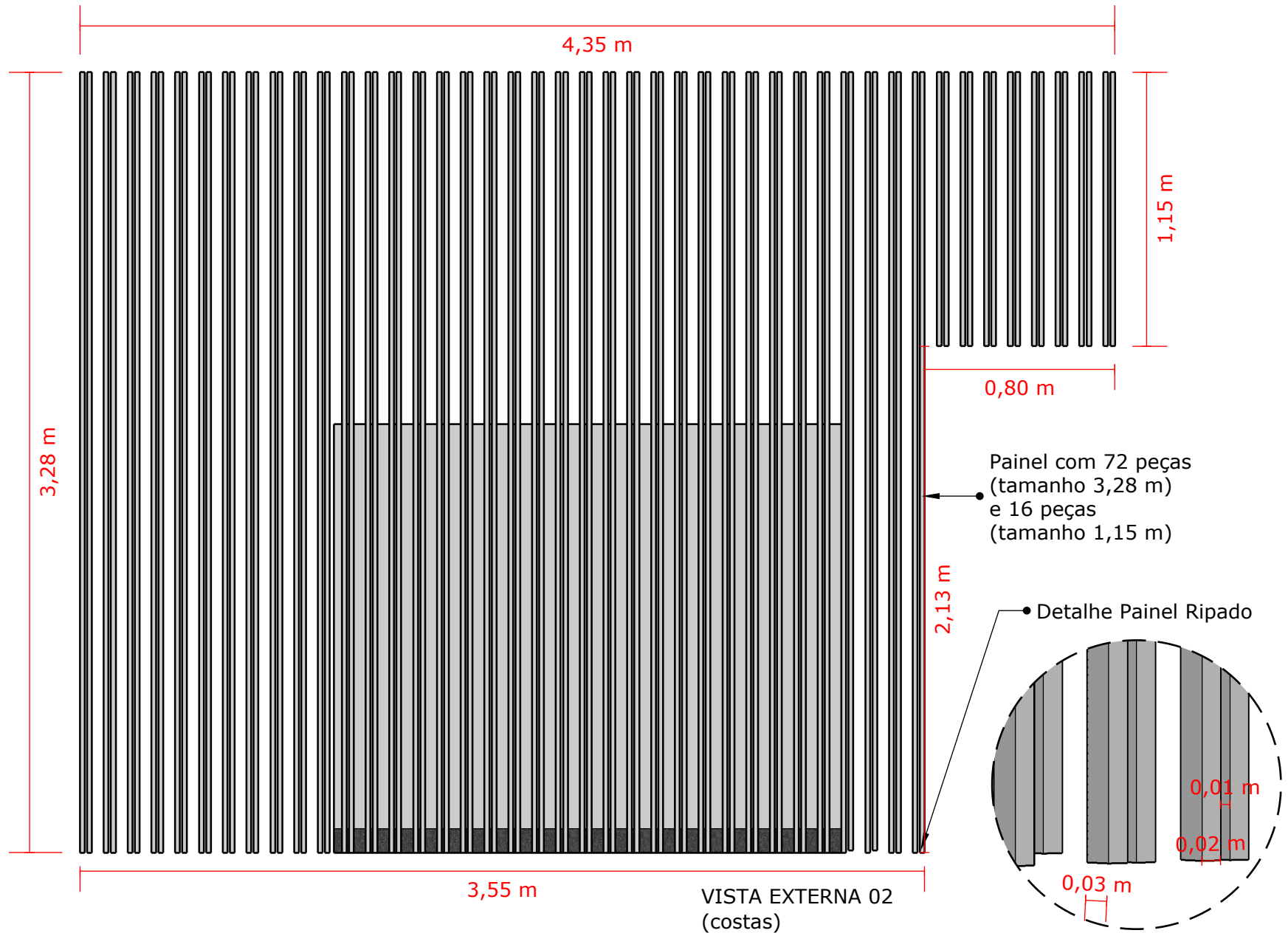



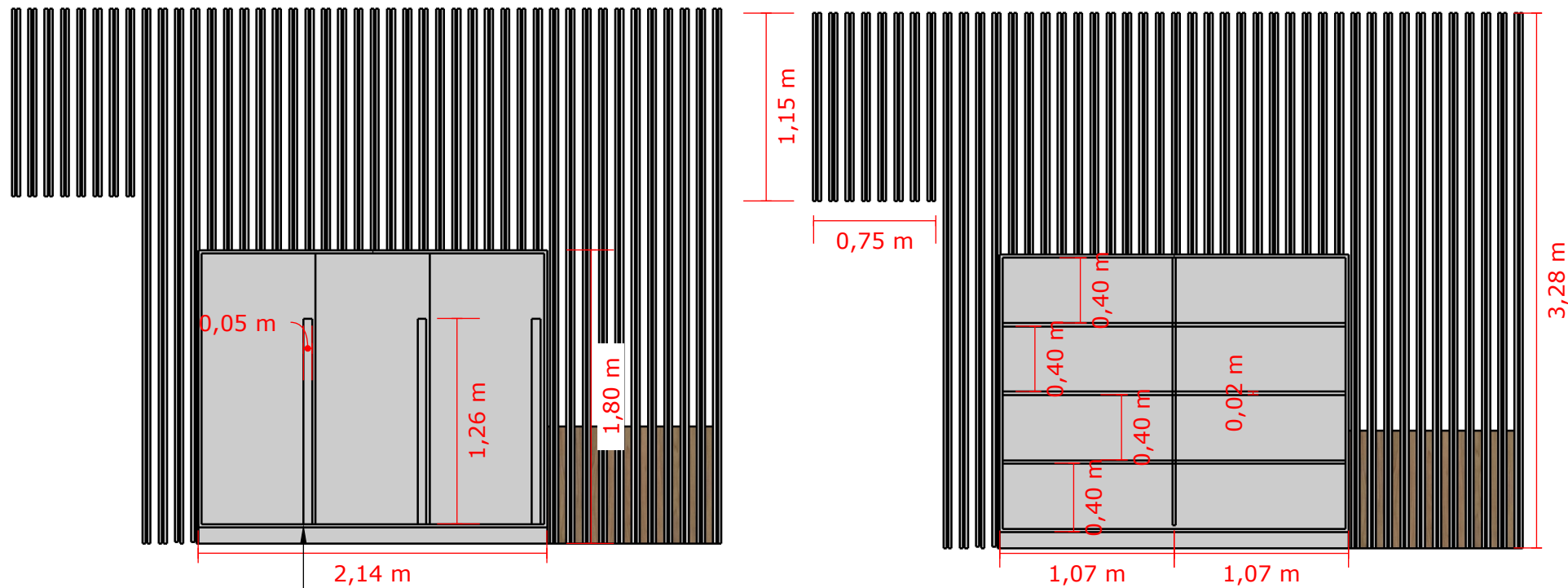

VISTA EXTERNA 02  
(frontal)

VISTA INTERNA 02  
(frontal)

- Puxador com afastamento de 0,02 m em relação a porta

MESAS E CADEIRAS  
EXISTENTES



VISTA EXTERNA 03  
(perspectiva)

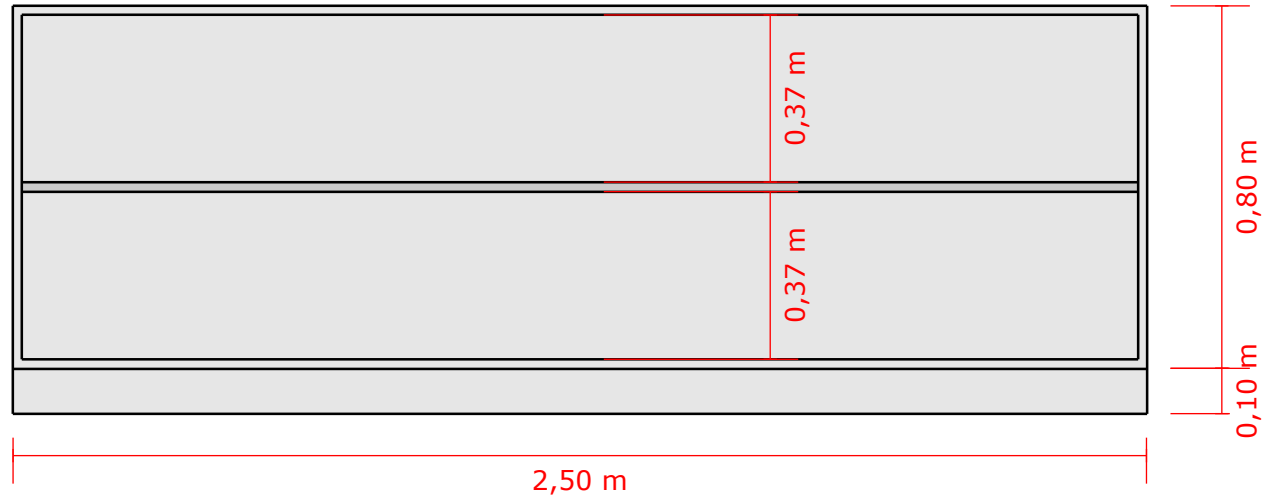

VISTA INTERNA 04  
(frontal)

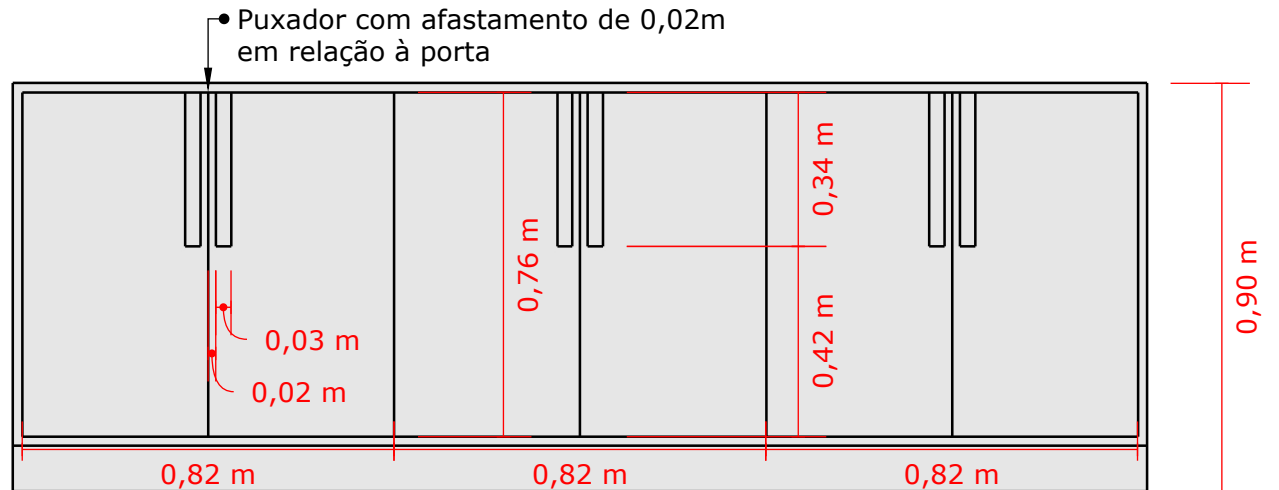

VISTA EXTERNA 04  
(frontal)



Sala  
03

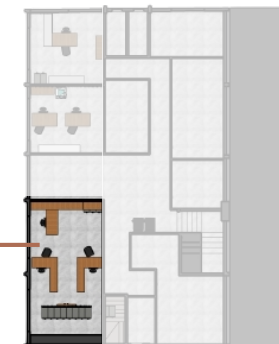

• O móvel não será executado, devido alterações em obra.

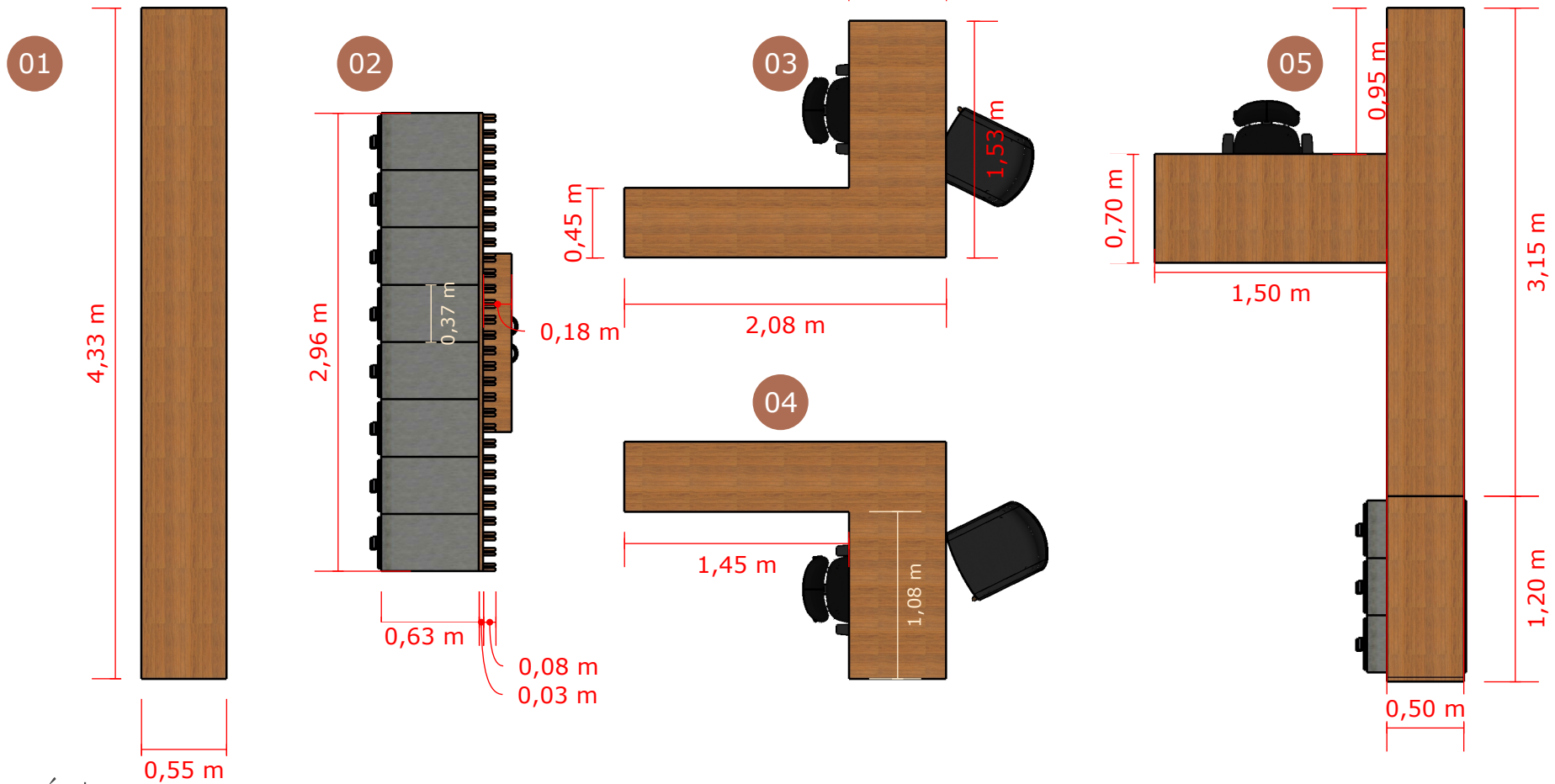

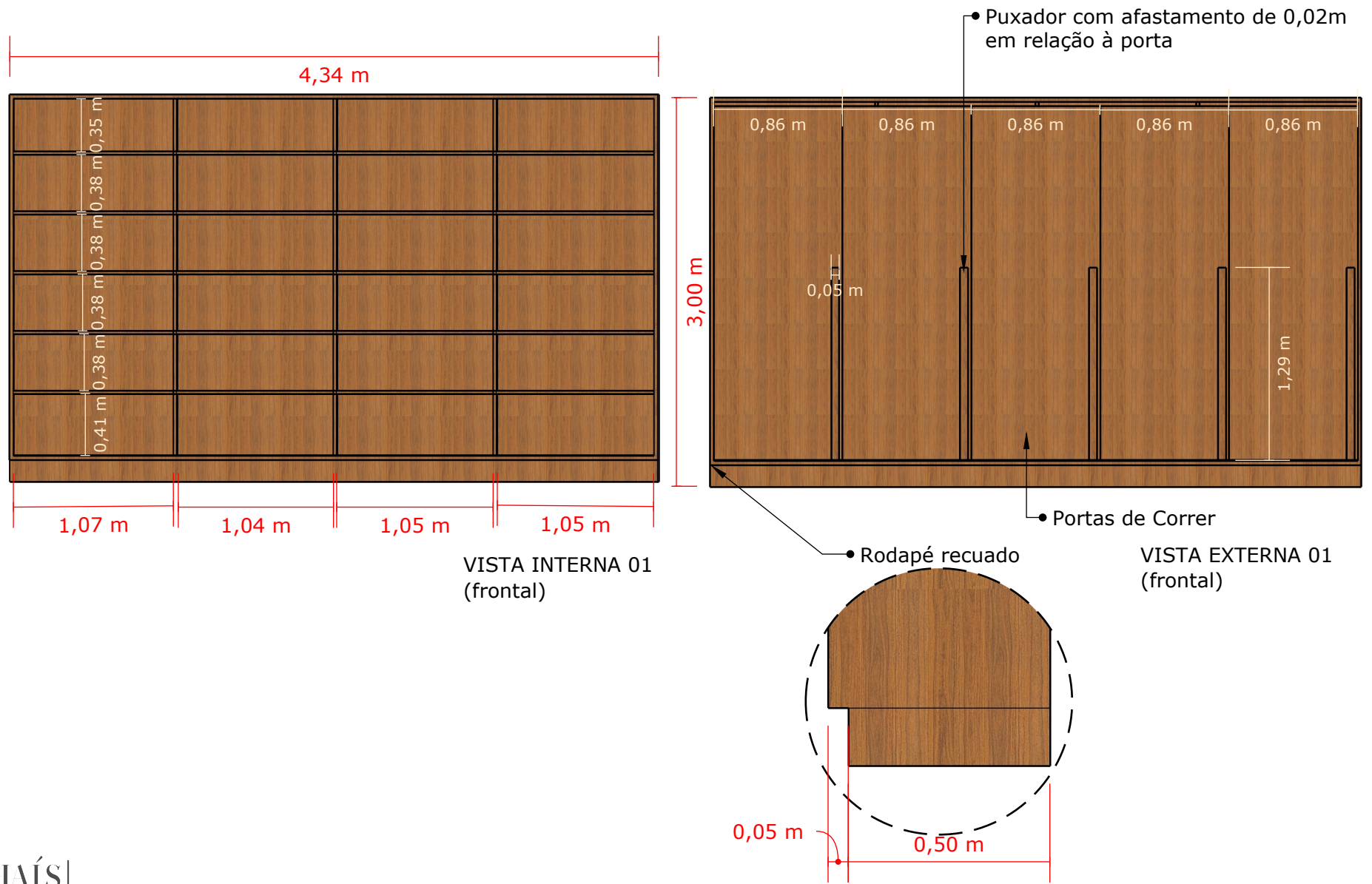

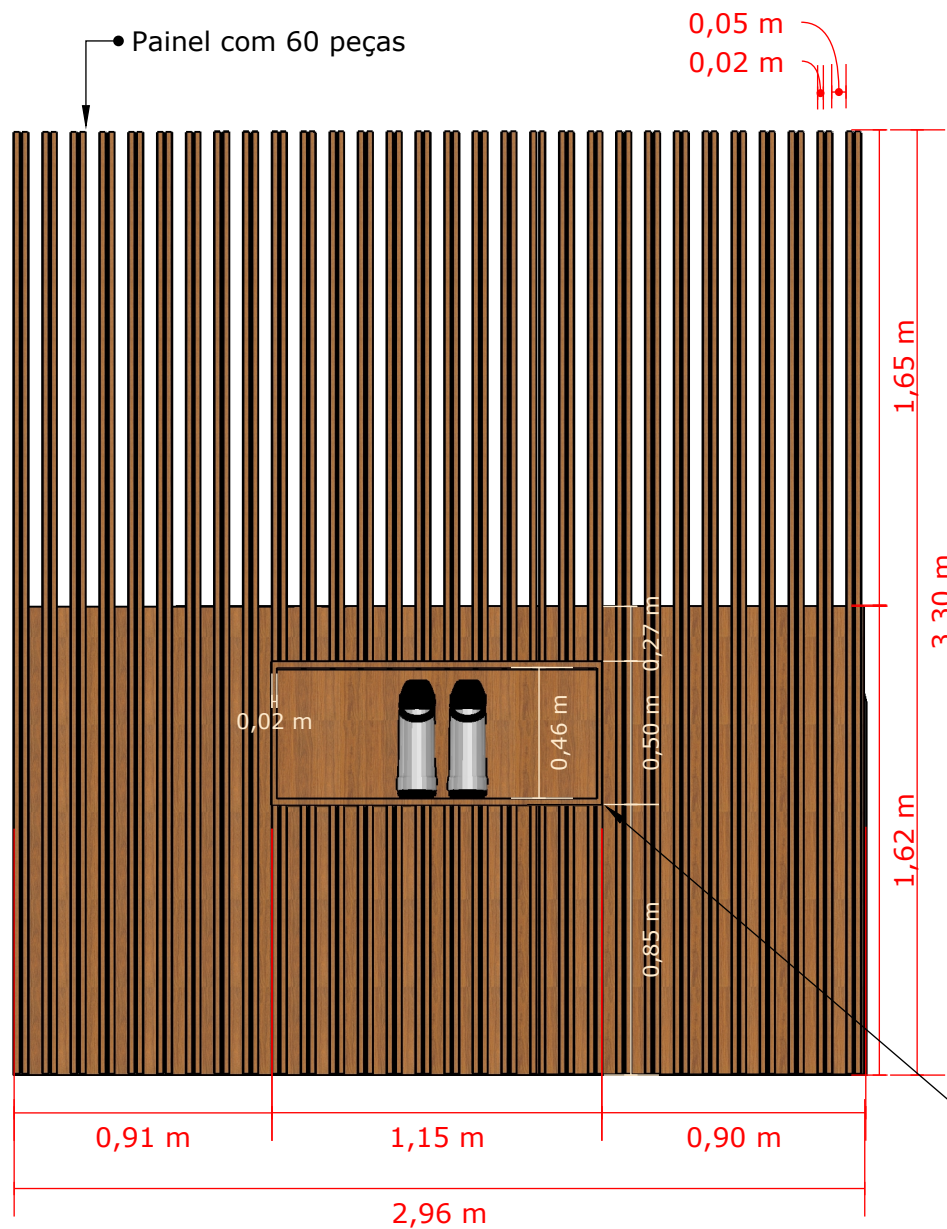

VISTA EXTERNA 02  
(recepção)

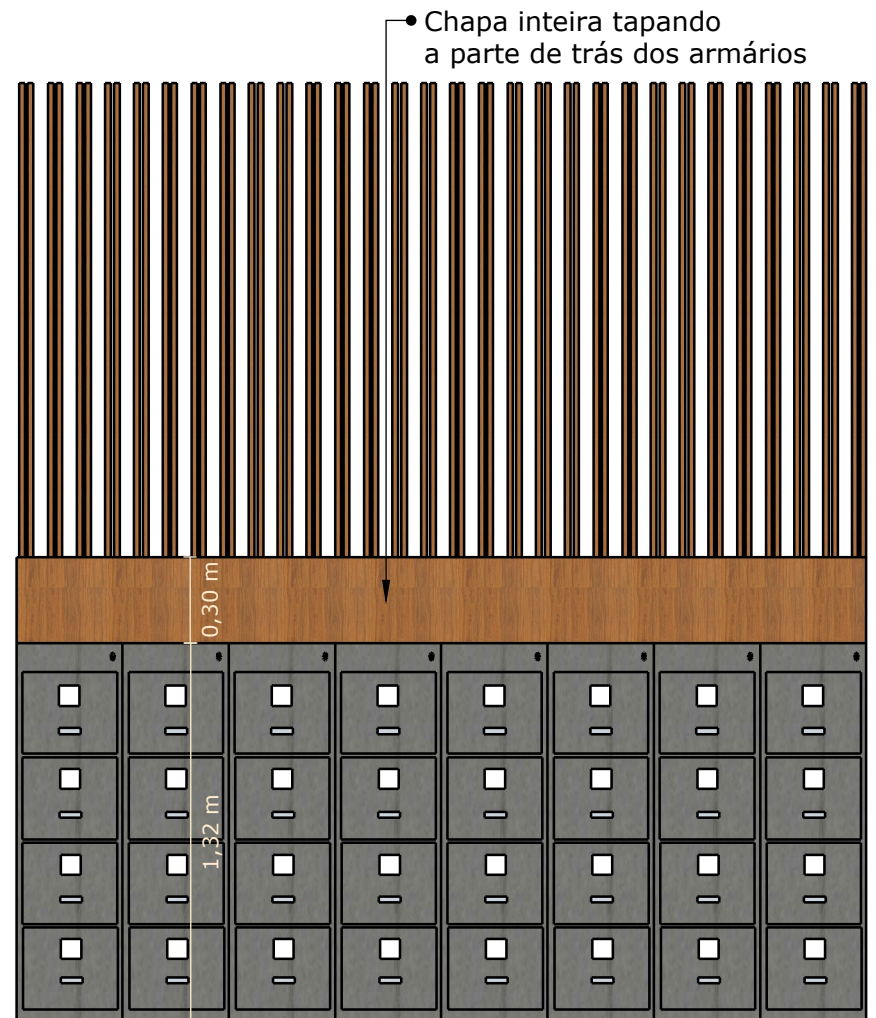

VISTA EXTERNA 02  
(armários)

• Prof. nicho  
0,15 m





VISTA EXTERNA 03 e 04  
(perspectiva)



VISTA EXTERNA  
(frontal)

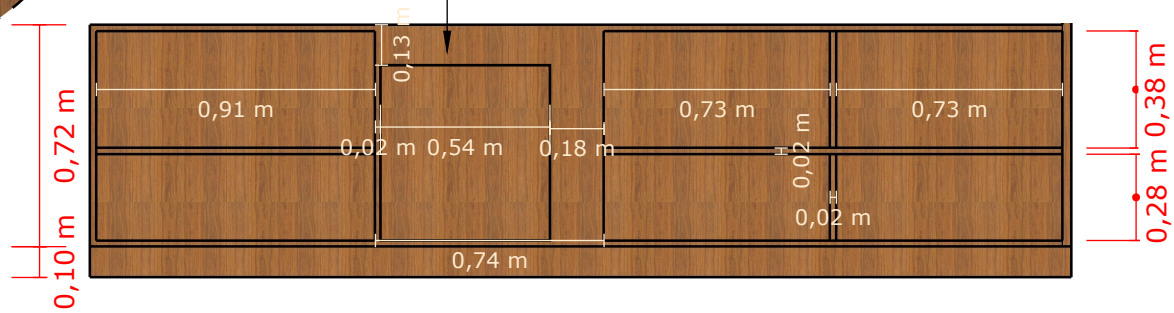
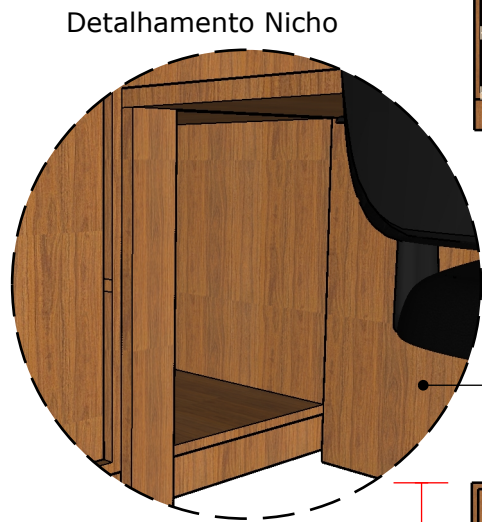
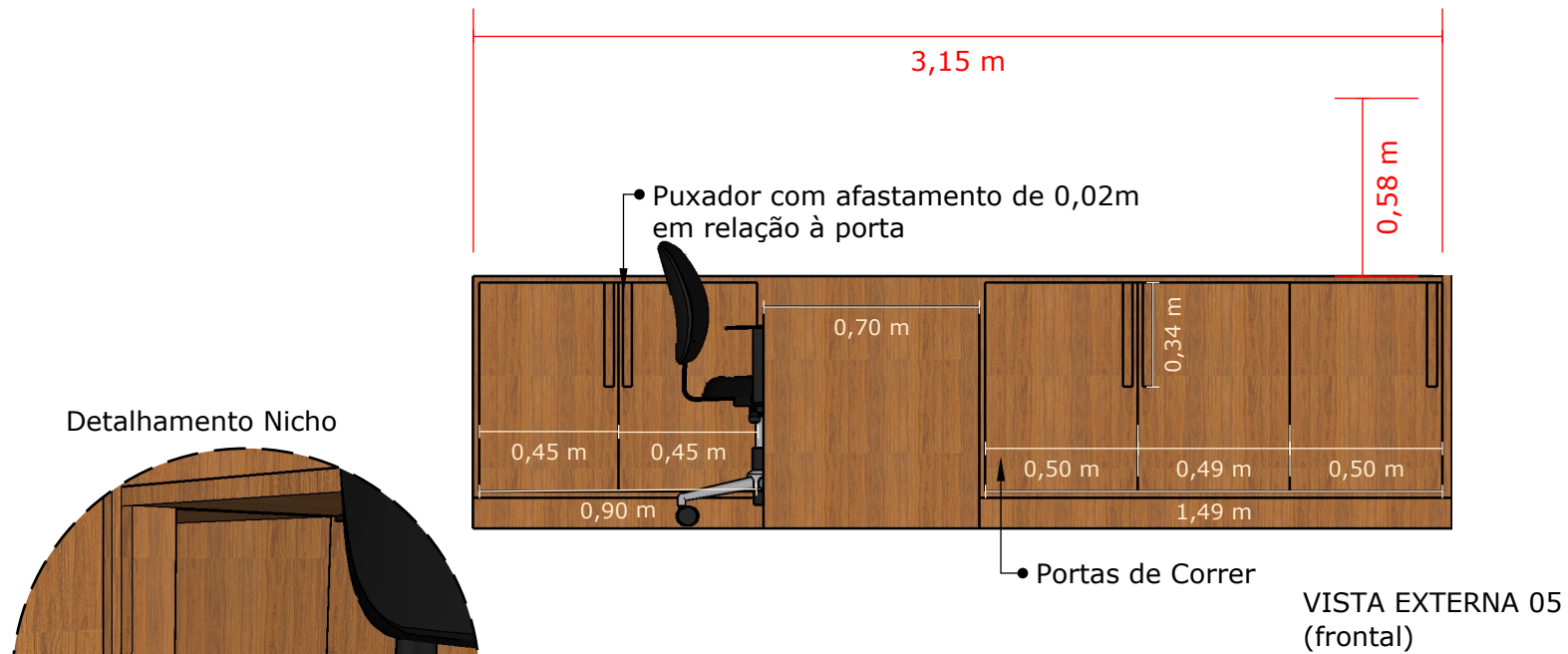





VISTA EXTERNA 05  
(perspectiva)

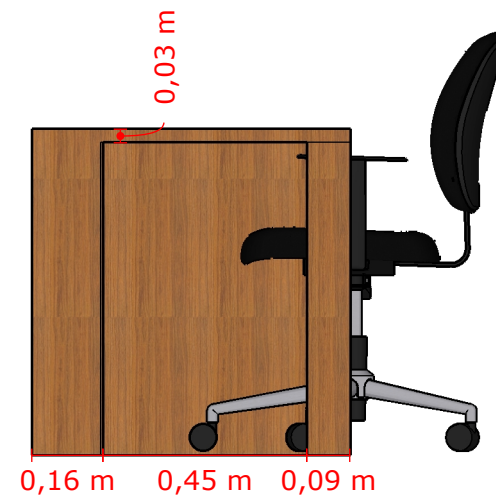

VISTA EXTERNA 05  
(lateral)



VISTA EXTERNA 05  
(perspectiva)